



71 Wedgewood Drive, Harlow, CM17 9PY
Guide Price £400,000



71 Wedgewood Drive, Harlow, CM17 9PY

Situated in 'Church Langley' is this fantastic three bedroom link detached house on 'Wedgewood Drive'. The property has lots to offer such as a spacious lounge, conservatory, downstairs WC, driveway plus parking as well as front and rear garden. The home is also close to local amenities as well as good schools. This property is also being sold with a COMPLETE CHAIN as the Vendor has already found somewhere! Call Now!



Entrance Hall

Doors leading to all rooms.

Downstairs WC

Closed couple WC with hand basin. Frosted window to front aspect.

Kitchen

8" x 7" (2.44m x 2.13m)

Eye and base level units with worksurfaces throughout, fitted oven and gas hob with extractor, sink with mixer tap and drainer, space for appliances. Window to front aspect.

Lounge/Diner

15" x 14'11" (4.57m x 4.55m)

Spacious Lounge/Diner with stairs to First Floor Landing, window to rear aspect and sliding door to Conservatory.

Conservatory

9'10" x 9" (3.00m x 2.74m)

Currently used as Dining Area and door to rear garden.

First Floor Landing

Doors leading to all rooms, cupboard and window to side aspect.

Bedroom One

11'10" x 8" (3.61m x 2.44m)

Fitted wardrobes and window to rear aspect.

Bedroom Two

11'10" x 8" (3.61m x 2.44m)

Fitted wardrobes and window to front aspect.

Bedroom Three

7" x 6" (2.13m x 1.83m)

Window to rear aspect.

Bathroom

Panel enclosed bath with mixer tap and shower attachment, Concealed WC with vanity hand basin and mixer tap as well as tiled floor and walls. Frosted Window to front aspect.

Exterior Rear

Mostly laid to lawn with flower bed borders, patio area and door to Garage.

Exterior Front

Paved driveway with parking for up to 2 cars and access to Garage. Front garden area also comprising of lawn and flower beds.

REFERENCE

LANES ESTATE AGENTS CHESHUNT





GROUND FLOOR

1ST FLOOR

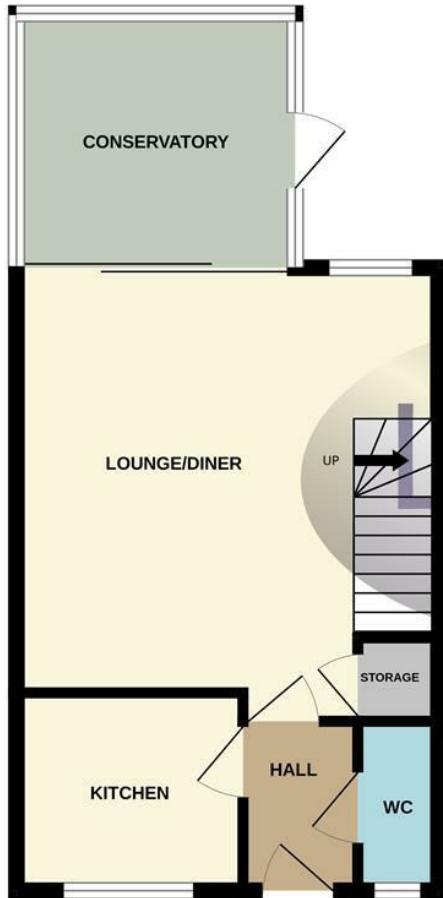

Whilst every attempt has been made to ensure the accuracy of the floorplan contained here, measurements of doors, windows, rooms and any other items are approximate and no responsibility is taken for any error, omission or mis-statement. This plan is for illustrative purposes only and should be used as such by any prospective purchaser. The services, systems and appliances shown have not been tested and no guarantee as to their operability or efficiency can be given.
Made with Metropix ©2023

IMPORTANT NOTICE TO PROSPECTIVE PURCHASERS

We are not qualified to test any apparatus, equipment, fixtures and fittings or services so cannot that they are in working order or fit for their intended purpose. We do not have access to property deeds or lease documents so prospective purchasers should rely only on information given by their solicitors on relevant matters. Measurements are approximate and are only intended to provide a guide.

